

AMS unit size : inch/mm							
ams Part Number	Andon Part Number Replace "XXX" with Terminal Type	Terminal Type			Pin Ø [in]	Figure Number	Page Number
CMV2000 (PGA)	10-12-06-095-XXX-R27-S14	Thru-Hole	Surface Mount	Rollerball®	.012	1	1
CMV4000 (PGA)	10-12-06-095-XXX-R27-S14	400T4	414T4	RB501T4	.012	1	1

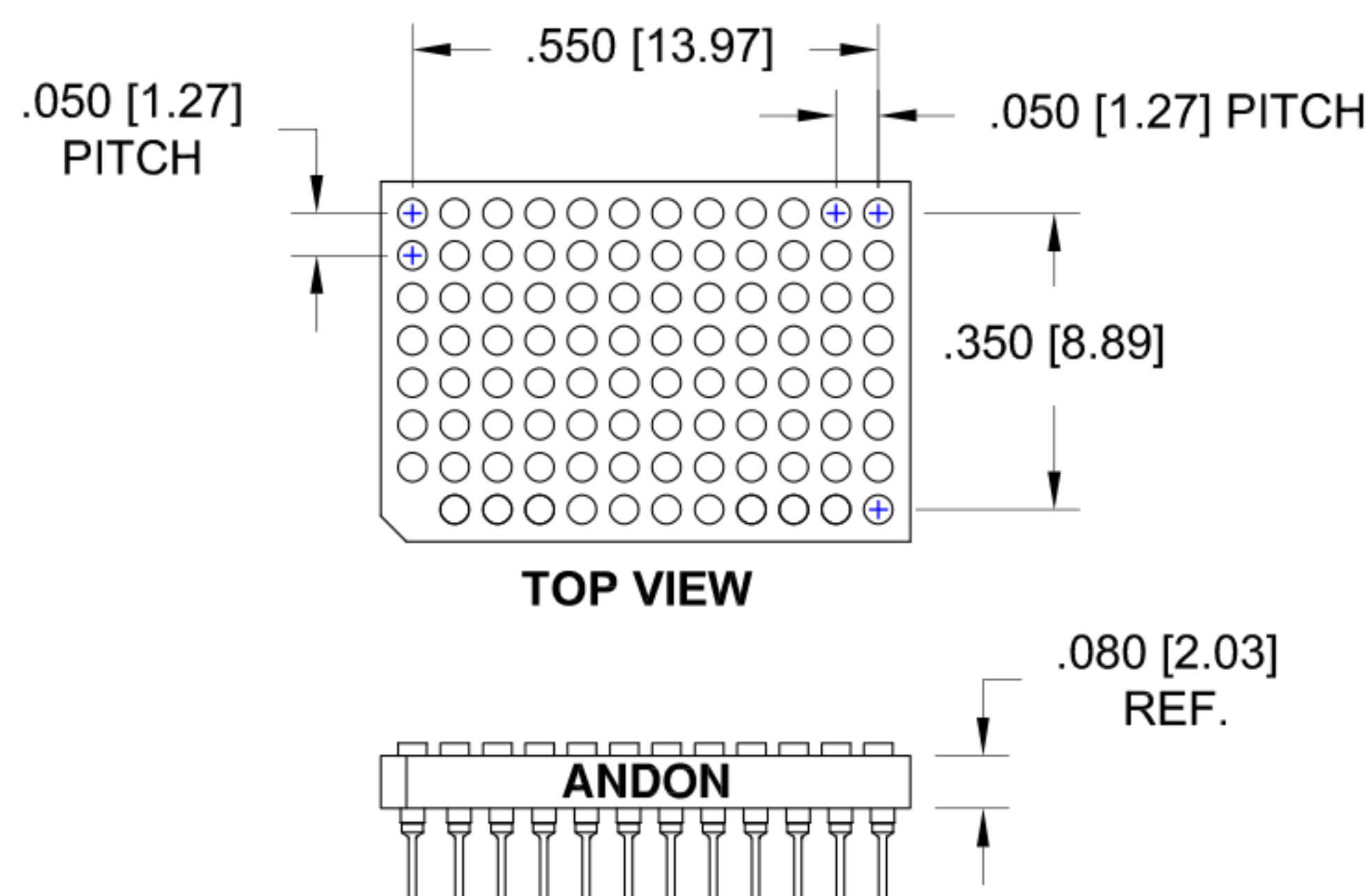
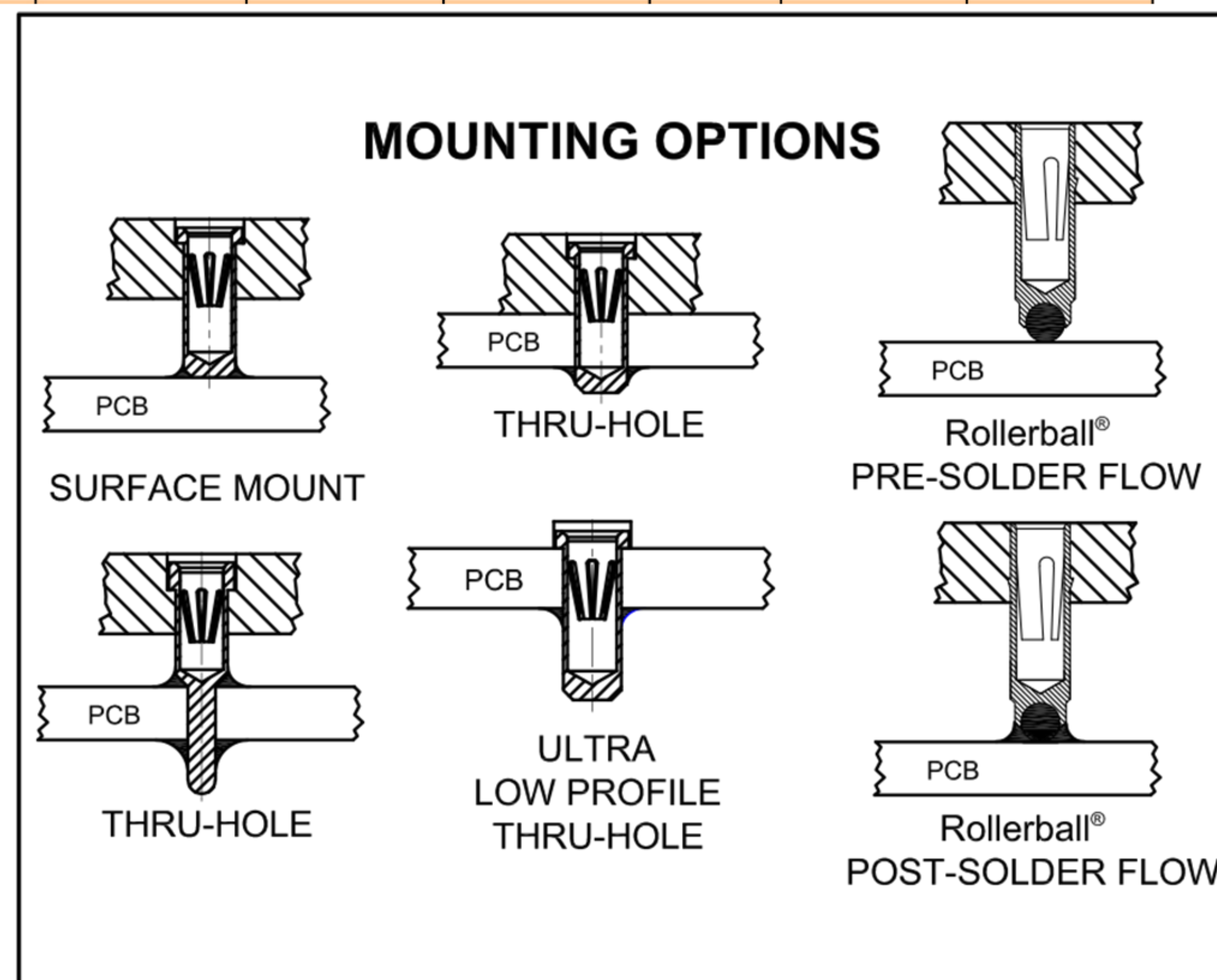
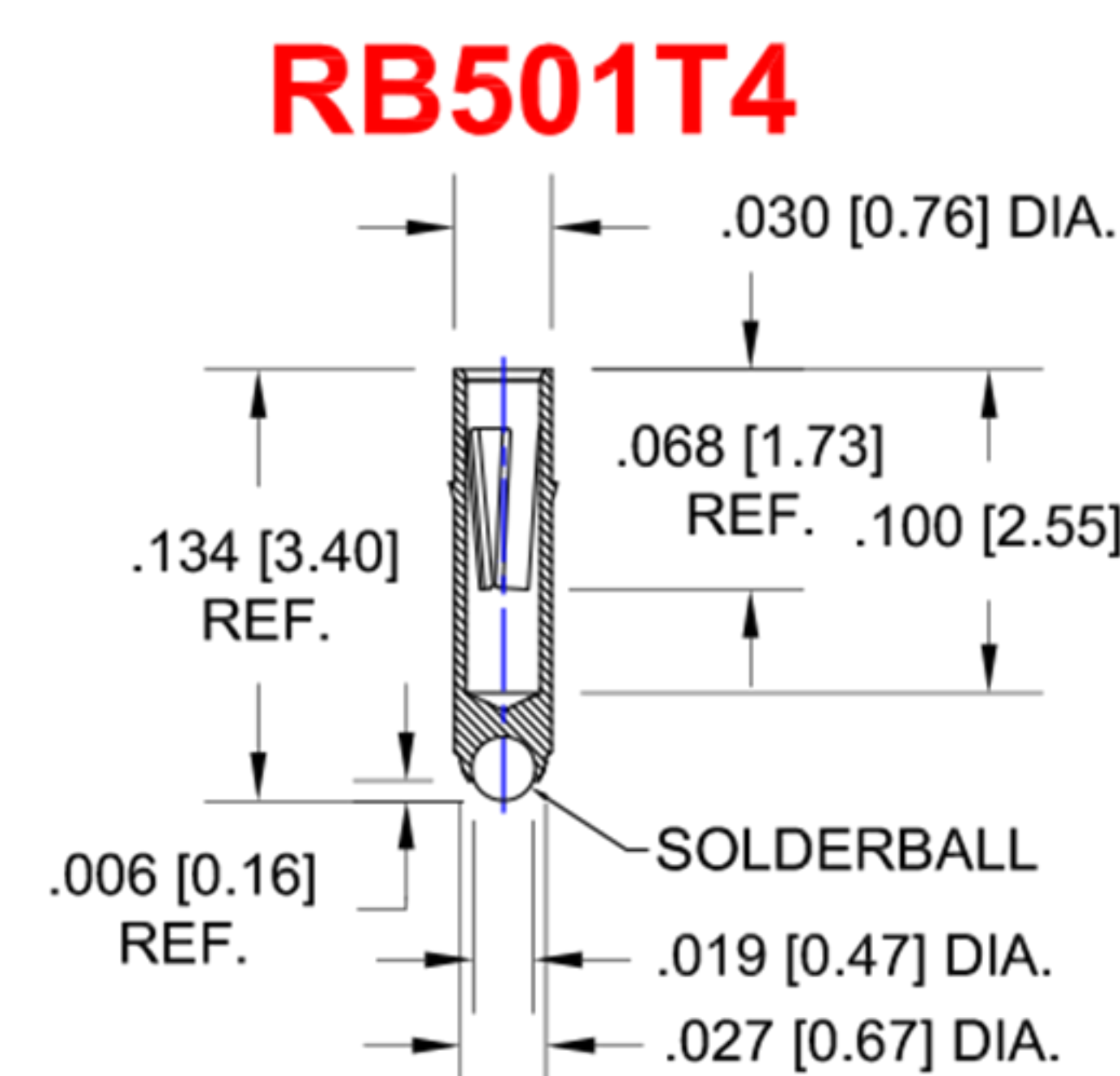
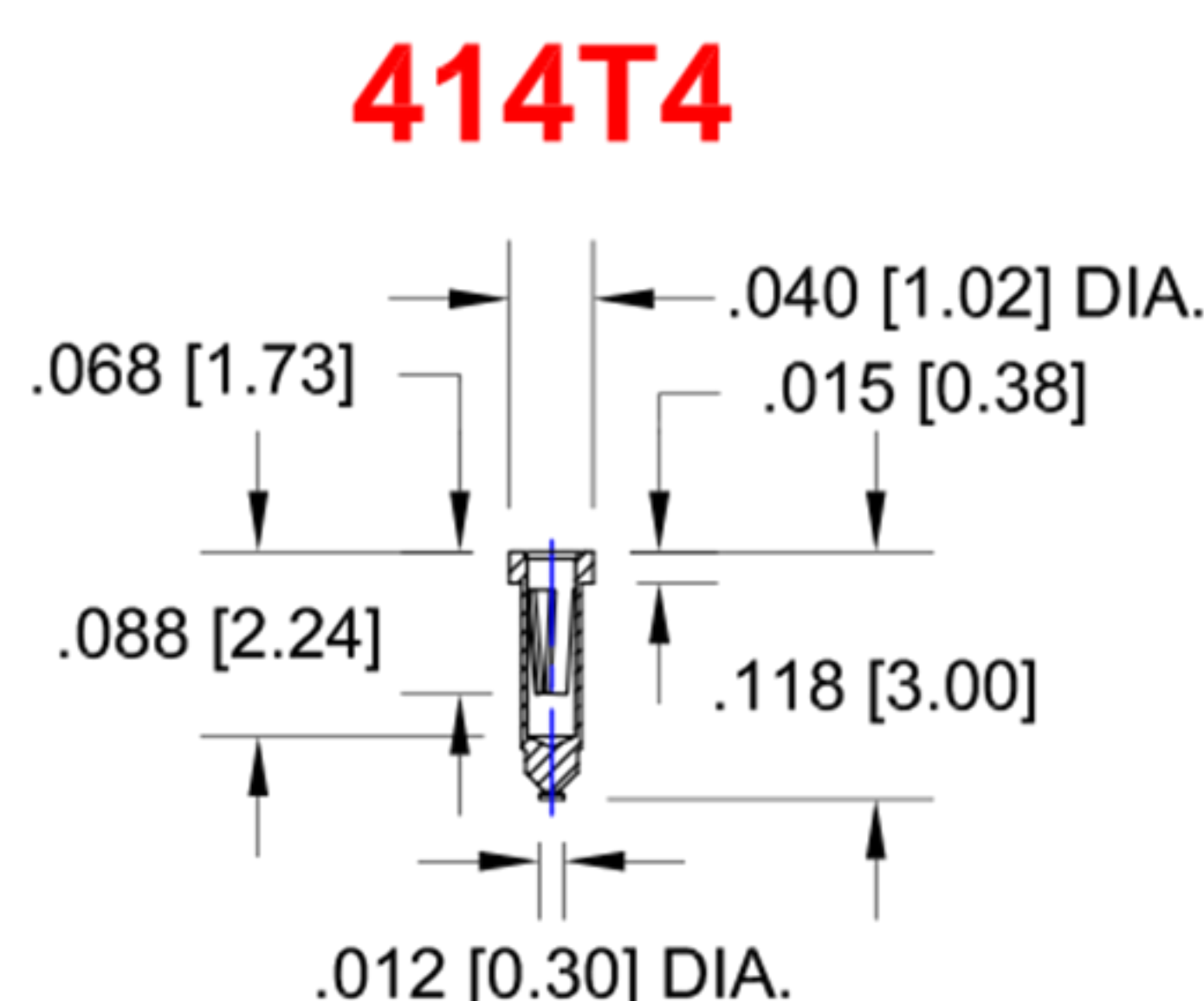
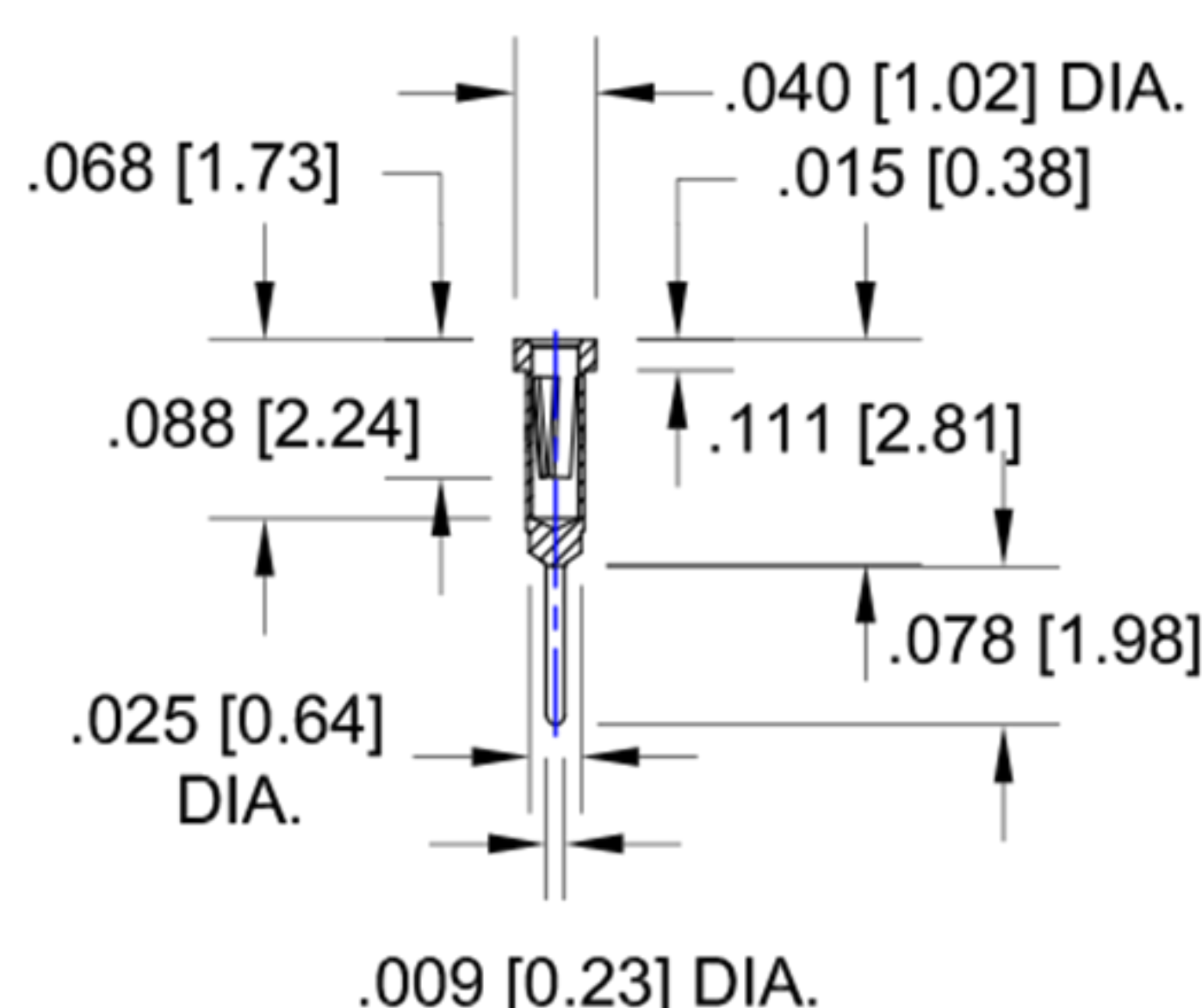

Fig. 1

Thru-Hole: 10-12-06-095-400T4-R27-S14
 Surface Mount: 10-12-06-095-414T4-R27-S14
 Rollerball® : 10-12-06-095-RB501T4-R27-S14



THRU HOLE OPTION 400T4 SURFACE MOUNT OPTION 414T4 ROLLERBALL® OPTION RB501T4



Technical Information

Material:

Insulator: Hi-Temp UL 94V-O
 -L14 Black FR4 Laminate
 -S14 Black Nylon 46 30% Glass Filled
 Terminal: Brass, per ASTM-B16
 Contact: BeCu, Per ASTM-B194
 Adapter: Copper Alloy Plated Gold
 Solderball: Lead Free 96.5% Tin, 3.0% Silver, 0.5% Copper

Plating: RoHS COMPLIANT
R27 TERMINAL: GOLD / CONTACT: GOLD
OTHER PLATINGS AVAILABLE

Thru Hole Terminal	Accepts Pin Diameter	Insertion Force	Withdrawal Force	Surface Mount Terminal	Accepts Pin Diameter	Insertion Force	Withdrawal Force
400T4	Ø.012 [Ø0.30]	1.05 oz Max	0.32 oz Min	414T4	Ø.012 [Ø0.30]	1.05 oz Max	0.32 oz Min
				RB501T4	Ø.012 [Ø0.30]	1.05 oz Max	0.32 oz Min